

**HUMAN AND ENVIRONMENTAL RECEPTORS
PROXIMATE TO FARM ROAD HOMES PROJECT**

**Compiled from plans submitted
to Sherborn Zoning Board of Appeals for
Farm Road Homes Project.**

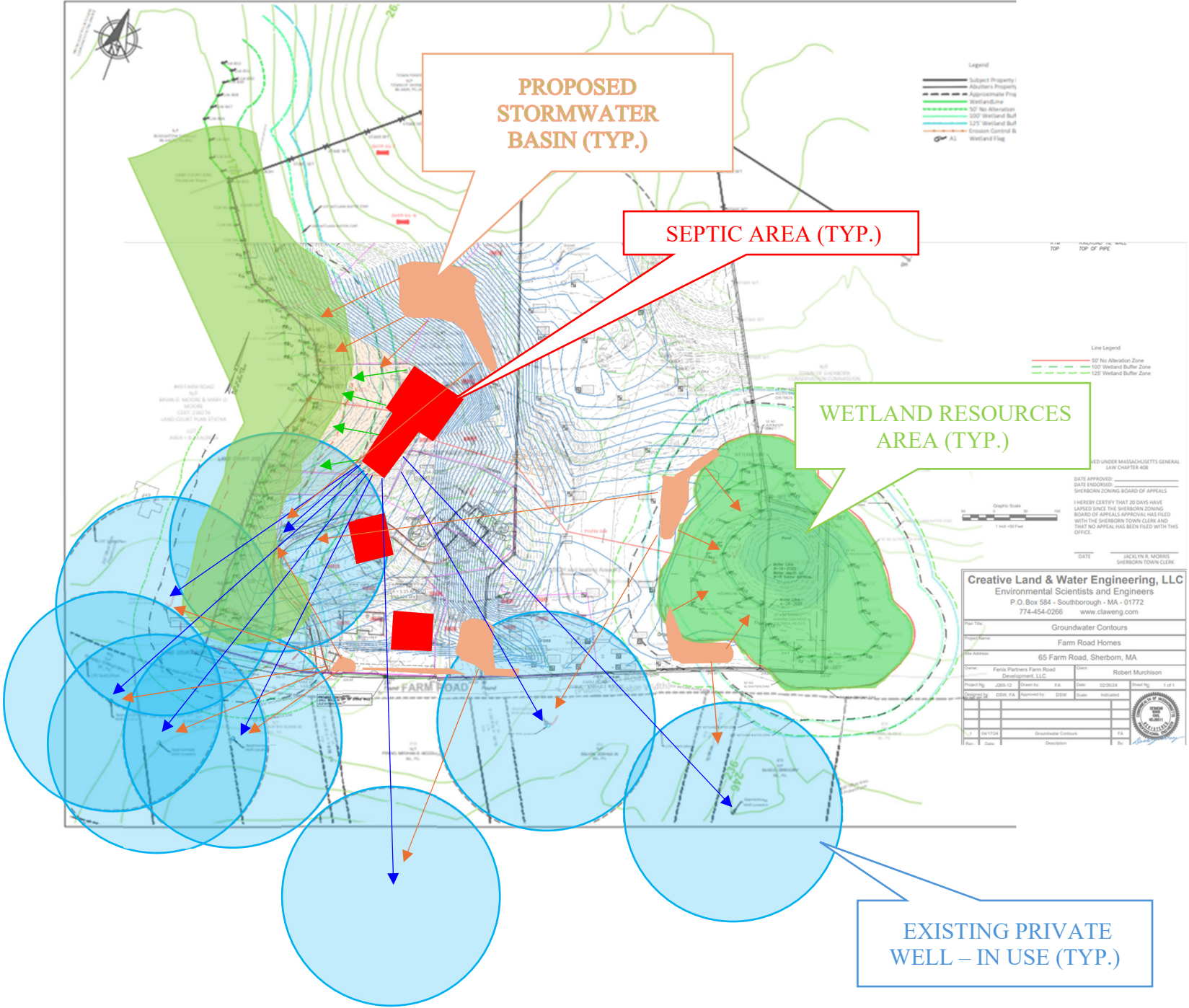

THIS IS A SIMPLIFIED VISUAL REMINDER ABOUT THE PROXIMITY OF THE EXISTENCE, LOCATION, AND PROXIMITY OF THE RESOURCE AREAS OUR NEIGHBORHOOD RELIES ON FOR DRINKING WATER RELATIVE TO THE FARM ROAD HOLMES PROJECT SITE. **NONE** OF THESE RESIDENTIAL DWELLINGS HAVE ANY CONTINGENCY PLANS FOR THEIR PRIVATE WATER SUPPLY WELLS.

THESE PRIVATE WATER SUPPLY WELLS SERVICE EIGHT SHERBORN RESIDENTIAL DWELLING USING CASED WELLS TO COLLECT BEDROCK FRACTURE/PORE WATER FROM DEPTHS RANGING FROM 40 TO 250 FEET BELOW GRADE WITH A TOTAL SERVICE/DESIGN FLOW OF AT LEAST 2,640 GALLONS PER DAY. “INTAKE” ELEVATIONS ARE **BENEATH** AND **DEEPER** **THAN** THOSE OF THE PROPOSED FARM ROAD HOMES SEPTIC SYSTEM.

THE FARM ROAD HOMES PROJECT IS PROJECTING A TOTAL DESIGN WATERWATER FLOW RATE OF 8,360 GALLONS PER DAY – A VOLUME **THREE (3) TIMES LARGER** THAN THE COMBINED NEARBY PRIVATE WATER SUPPLY WELL EXTRACTION RATE.

EACH BLUE LEADER REPRESENTS APPROXIMATELY 330 GALLONS OF EFFLUENT FLOW FROM THE PROPOSED SEPTIC TO THE PRIVATE WATER WELLS. EACH GREEN ARROW REPRESENTS THE REMAINING TITLE 5 FLOW FROM THE SEPTIC SYSTEM THAT WILL FLOW INTO THE WETLANDS. EACH PEACH COLORED LEADER REPRESENTS STORMWATER FLOW FROM THE COMBINED STORMWATER SYSTEM TO THESE RESOURCES.

NO NITROGEN TESTING HAS YET TO BE CONDUCTED, AND NO MODEL HAS BEEN PRESENTED BY THE APPLICANT THAT ACCURATELY REFLECTS THE REAL HUMAN HEALTH RISK(S) AND ENVIRONMENTAL HAZARD(S) POSED TO THESE RECEPTORS FROM THE PROPOSED FARM ROAD HOMES DEVELOPMENT.