

TRUCK TURN PLAN

CO RAIL CORPORATION
BK.13554/PG.581

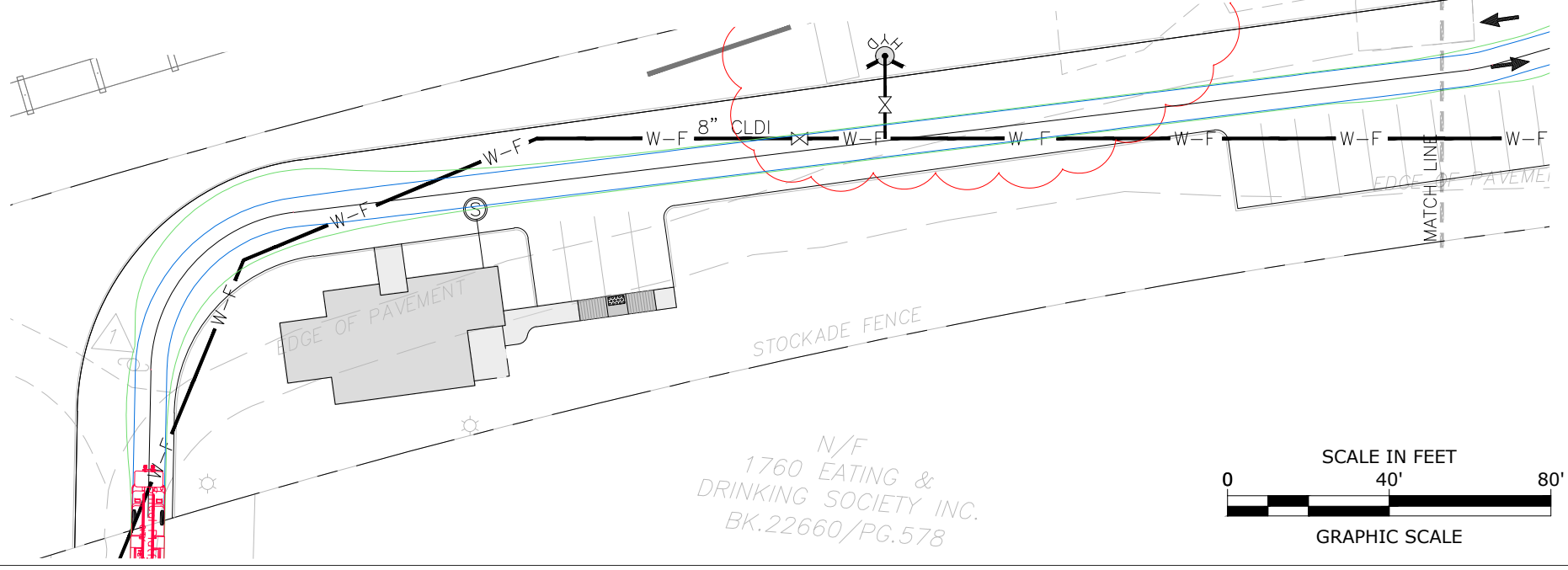

N/F
1760 EATING &
DRINKING SOCIETY INC.
BK.22660/PG.578

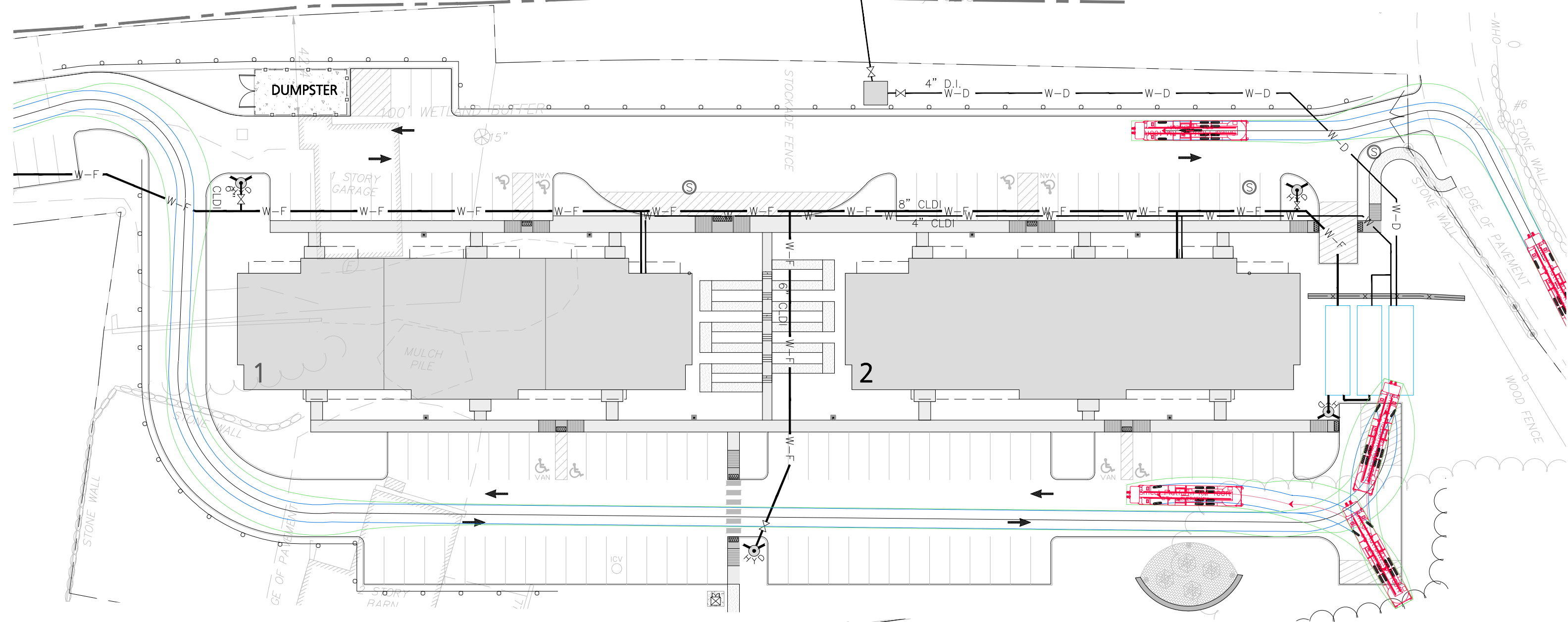
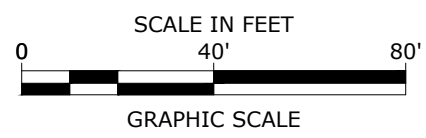

FRAMINGHAM

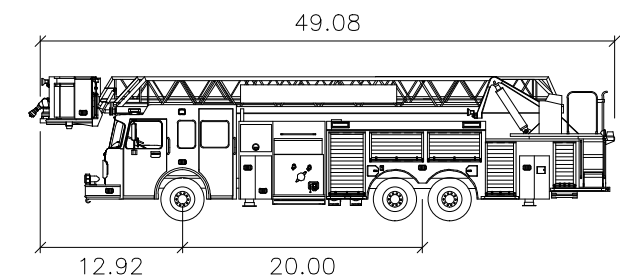

Smeal Platform RM 100ft

	feet
Width	: 8.33
Track	: 7.83
Lock to Lock Time	: 6.0
Steering Angle	: 48.0

ASHLAND

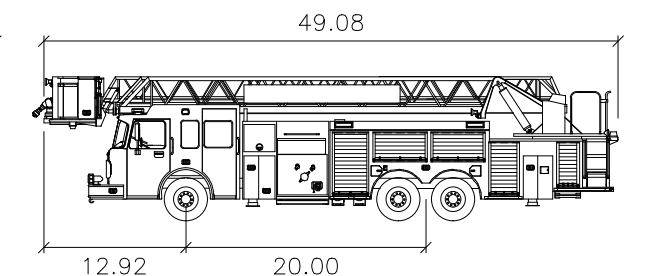

Smeal Platform RM 100ft

	feet
Width	: 8.33
Track	: 7.83
Lock to Lock Time	: 6.0
Steering Angle	: 48.0

TRUCK TURN PLAN

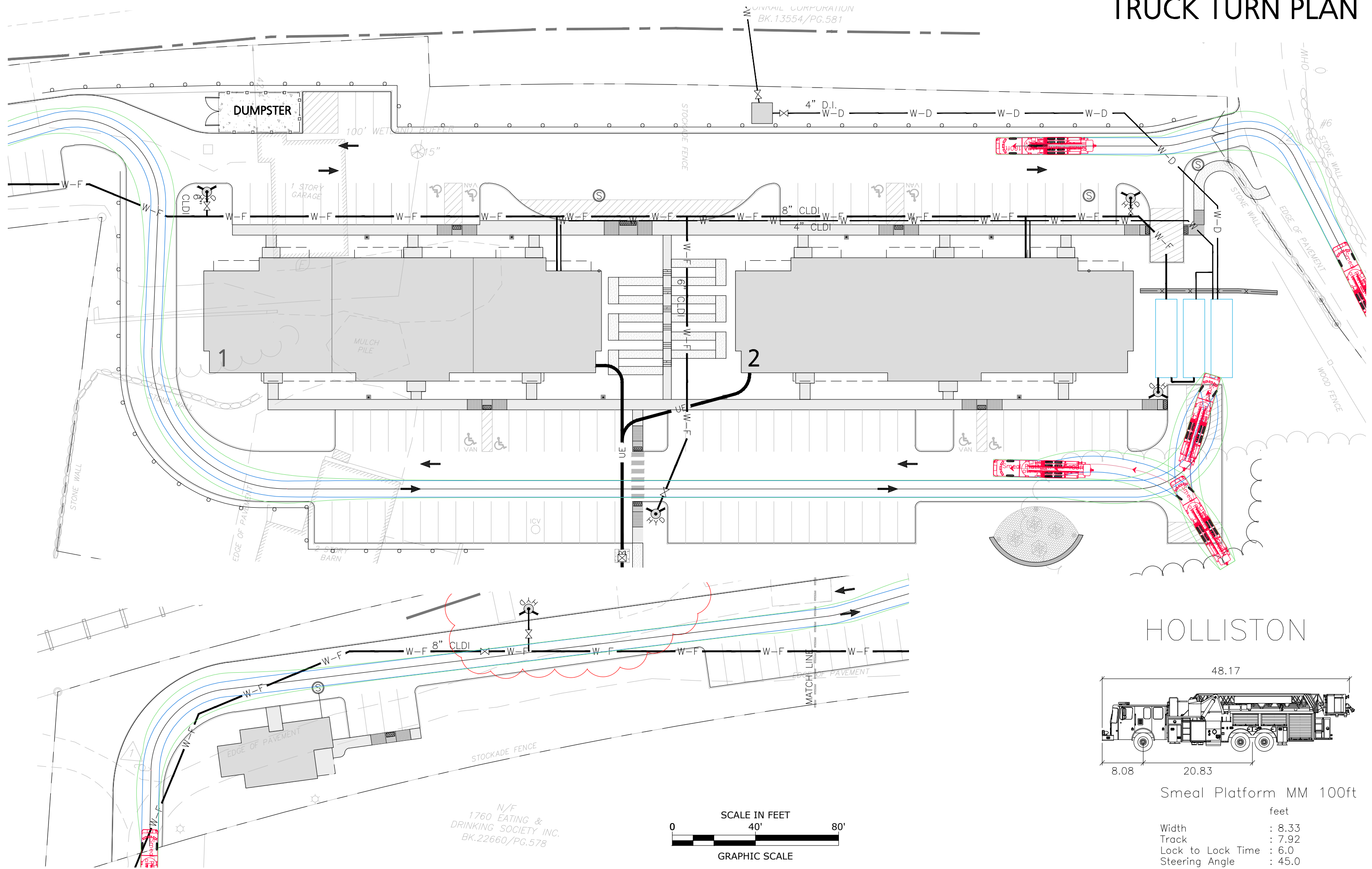

UNRAIL CORPORATION
BK.13554/PG.581

N/F
1760 EATING &
DRINKING SOCIETY INC.
BK.22660/PG.578

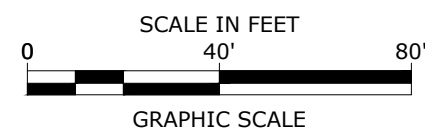

HOLLISTON

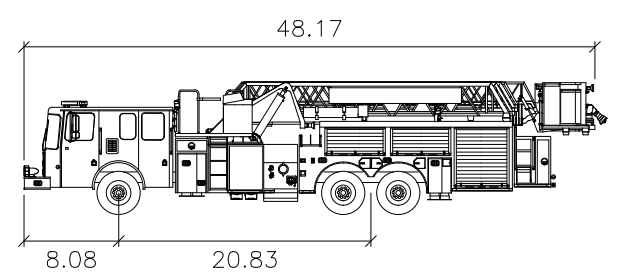

Smeal Platform MM 100ft

	feet
Width	: 8.33
Track	: 7.92
Lock to Lock Time	: 6.0
Steering Angle	: 45.0

TRUCK TURN PLAN

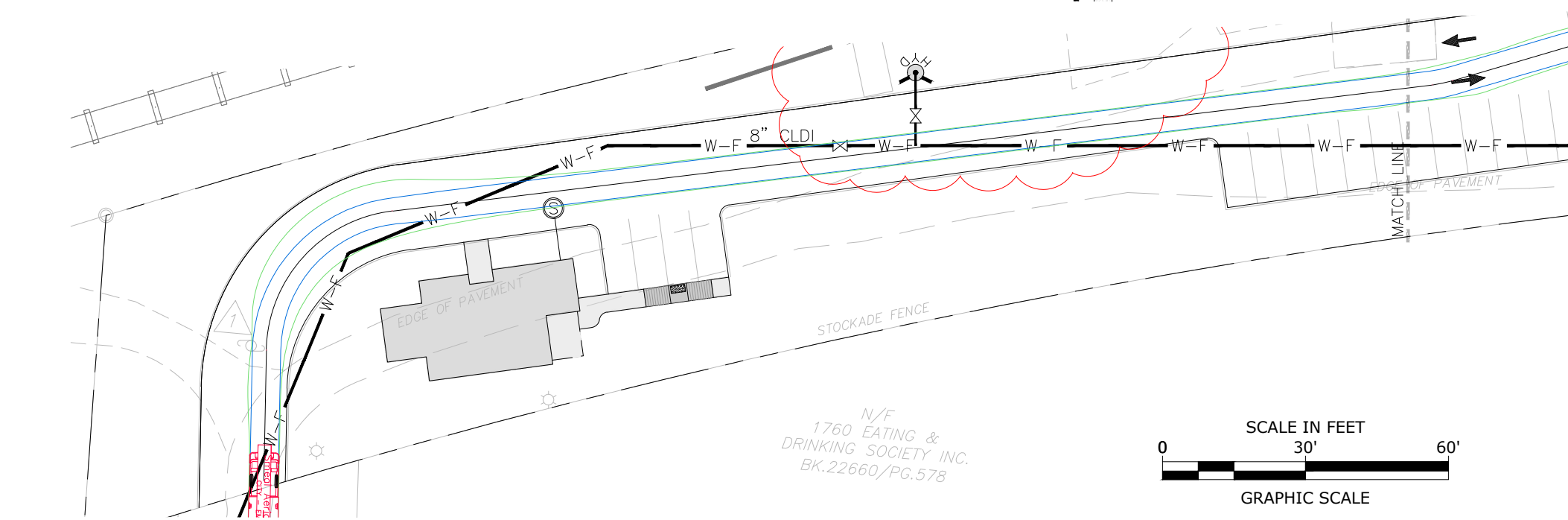
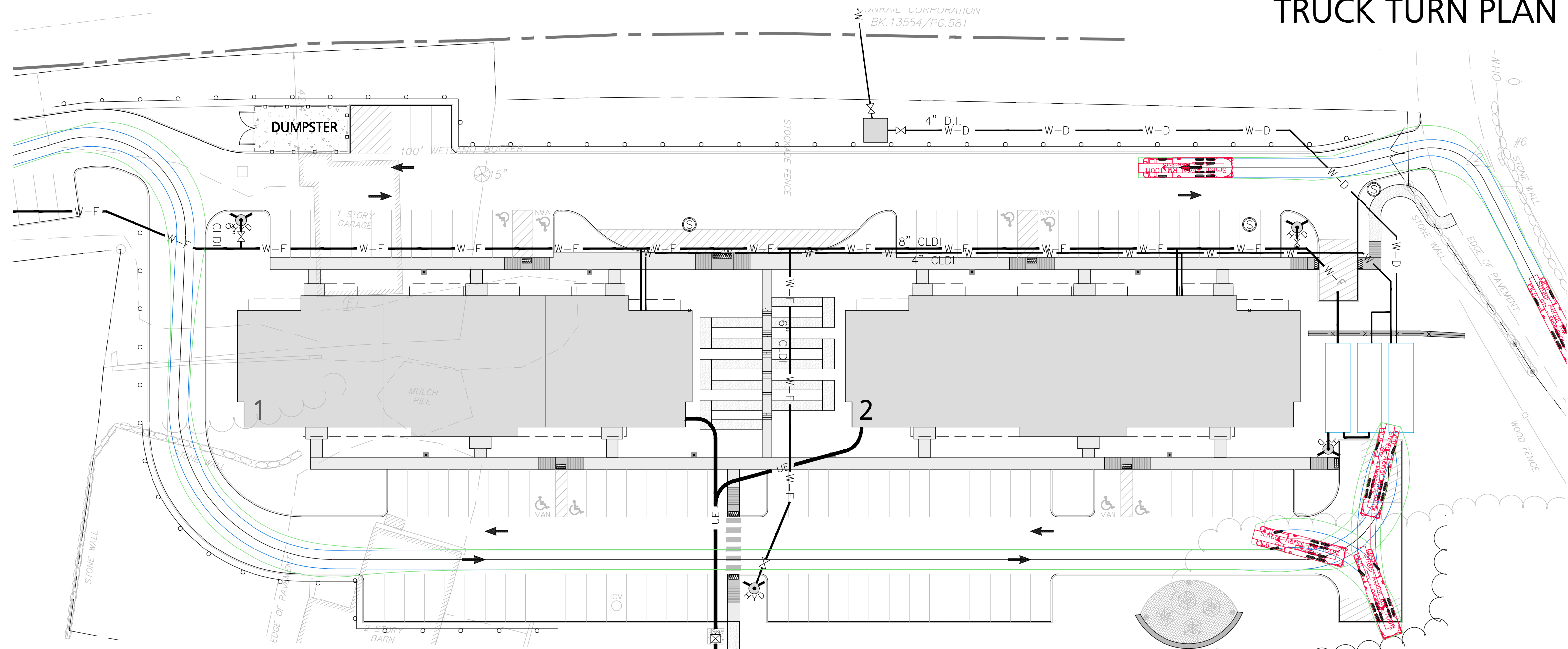

N/F
1760 EATING &
DRINKING SOCIETY INC.
BK.22660/PG.578

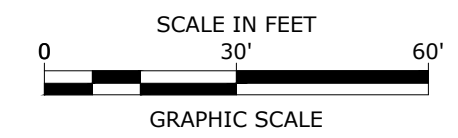

NATICK

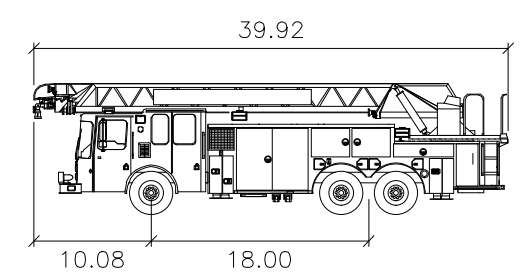

Smeal Aerial RM 100ft

	feet
Width	: 8.33
Track	: 7.92
Lock to Lock Time	: 6.0
Steering Angle	: 45.0

TRUCK TURN PLAN

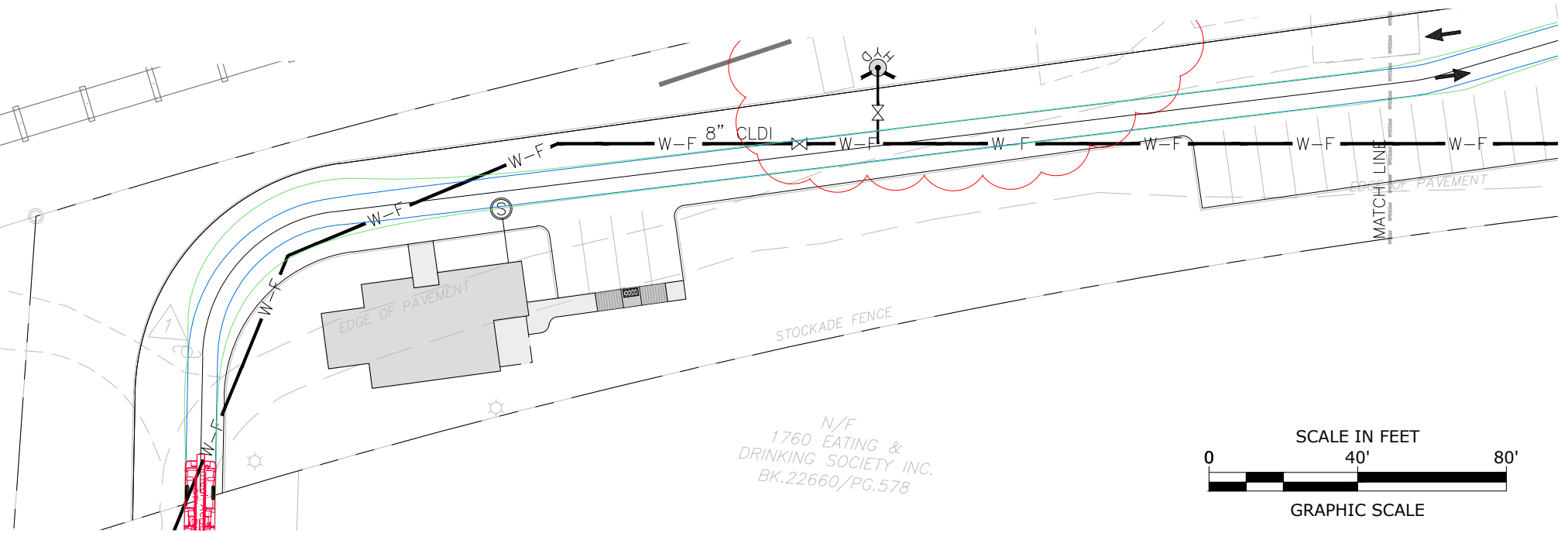
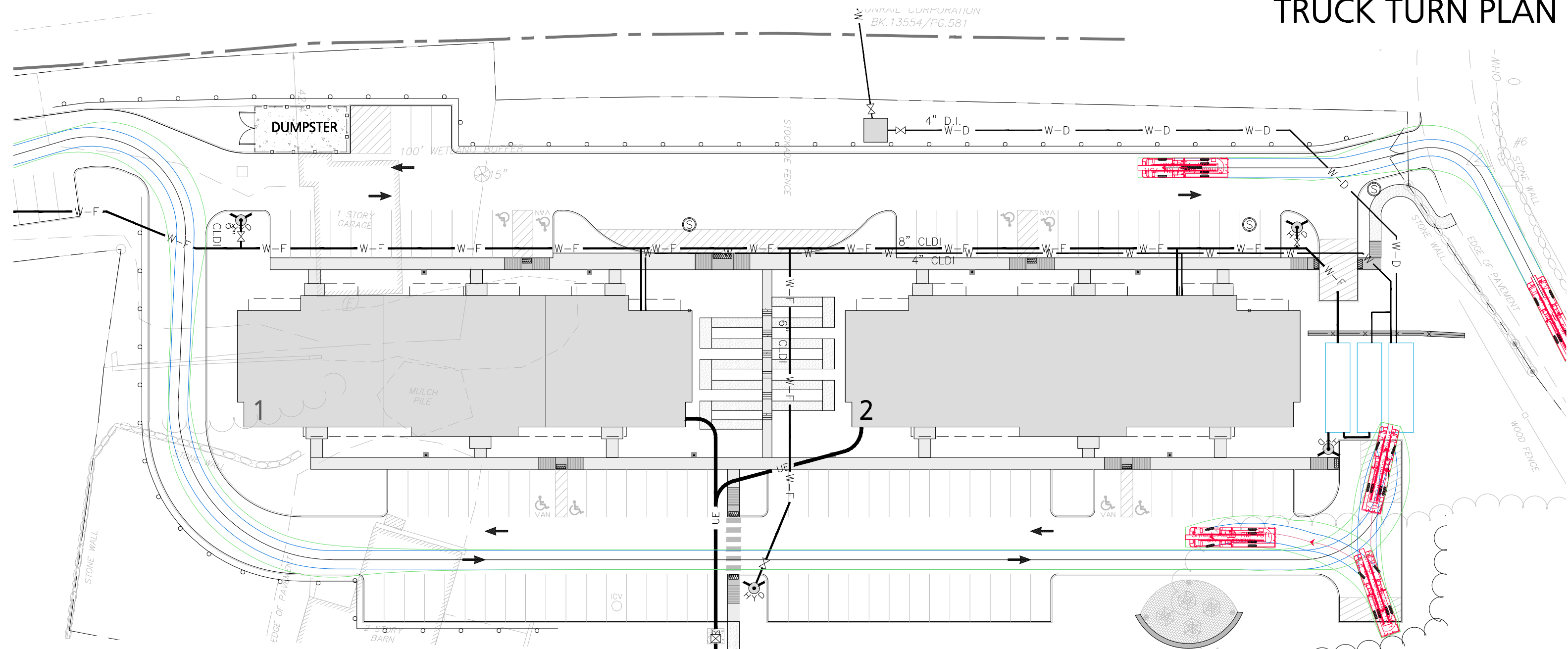

SHERBORN

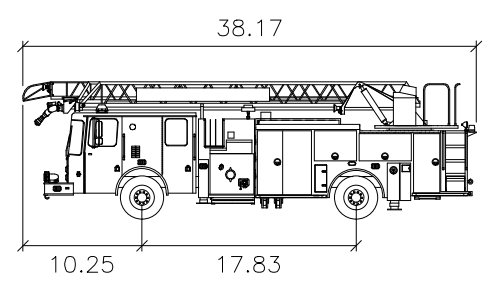

Smeal Aerial RM 75ft

	feet
Width	: 8.33
Track	: 7.92
Lock to Lock Time	: 6.0
Steering Angle	: 45.0

MEDFIELD

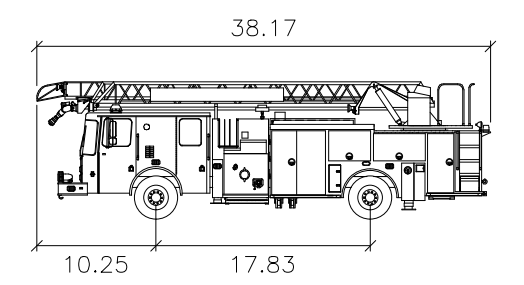

Smeal Aerial RM 75ft

	feet
Width	: 8.33
Track	: 7.92
Lock to Lock Time	: 6.0
Steering Angle	: 45.0

N/F
1760 EATING &
DRINKING SOCIETY INC.
BK.22660/PG.578

